

(2+1)x1 Multimode Fiber Combiner

Features	
High Coupling Efficiency & Low Insertion Loss High Power High stability and reliability	
Application	
Fiber Laser High Power Amplifier	

Specification

Working WL (nm)	Input pump	Input signal	Output fiber	Signal IL Spec	Pump Effi. spec	Package
1060	105/125 0.22	HI1060	6/125 0.14/0.46	0.5dB	90%	3x54mm 70x12x8mm
1060	105/125 0.22	HI1060	20/125 0.08/0.46	0.5dB	90%	
1060	105/125 0.22	6/125 0.14/0.46	6/125 0.14/0.46	0.5dB	90%	
1550	105/125 0.22	SMF-28	8/125 0.14/0.46	0.5dB	90%	
1550	105/125 0.22	8/125 0.14/0.46	8/125 0.14/0.46	0.5dB	90%	
1060	105/125 0.22	HI1060	10/125 DCF	0.5dB	90%	
1060	105/125 0.22	10/125 DCF	10/125 DCF	0.5dB	90%	
1060	105/125 0.22	20/125 DCF	20/125 DCF	0.5dB	90%	

Package Dimensions

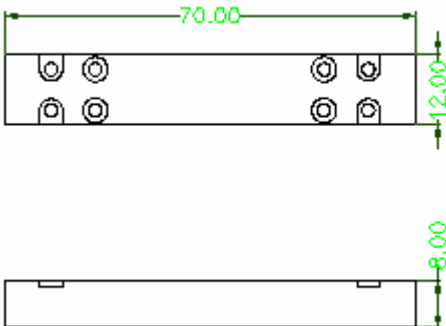

Ordering Information

MPC	Port Type	Pump fiber	Signal fiber	Output fiber	Length	Package
	(2+1)x1	105/125 0.22	HI1060 6/125 DC 20/125 DC 10/125 DC 20/125 DC 25/250 DC	6/125 DC 20/125 DC 10/125 DC 20/125 DC 25/250 DC	0.8=0.8m 1=1m	3x54 70x12x8